

# ENGLISH

To ensure best use of your device, carefully read these instructions. Keep this manual for future reference.

## PRODUCT OVERVIEW

1. Earbuds
2. Speaker
3. Touch controls (Earbuds)
4. Bluetooth & charging LED indicators (Earbuds/Speaker)
5. Microphones (Earbuds)
6. Opening button (Earbuds)
7. Power On/Off (Speaker)
8. USB type-C port
9. Charging case

## FEATURES

- True Wireless Stereo Earbuds
- 3W Bluetooth® speaker
- Dual microphone
- Environmental noise cancellation
- Rechargeable battery

## GETTING STARTED

Make sure to fully charge Speakerbuds:

1. Plug the supplied USB Type-C cable into the charging port of Speakerbuds case.
2. Plug the USB end of the cable into any 5V-1A power adapter
3. Plug the power adapter to a power source for about 2 hours

When the charging case is powered, the light indicator next to the charging port turns red.  
 When the charging case is fully charged, the light indicator next to the charging port turns off.

## PAIRING INSTRUCTIONS

### Earbuds - Bluetooth pairing



1. Open the charging case and take out both earbuds.
2. Turn On the Bluetooth on your mobile device. Then select **LEXON BUDS**.

To resume the pairing mode, please put both earbuds back in the charging case for a few seconds then take them out again.

### Speaker - Bluetooth pairing



1. Press and hold the button for 3 seconds to turn On the speaker.
2. Make sure the Bluetooth is enabled on your mobile device. Then select **LEXON SPEAKER**.

Note: Bluetooth pairing mode will automatically stop and auto power off after 10 minutes of searching for device.

## LED information

| Earbuds     | Status                 | LED status                  |
|-------------|------------------------|-----------------------------|
|             | Ready to pair          | Red & blue LED flash slowly |
|             | Connected              | LED Off                     |
|             | Playing music          | LED Off                     |
| Low battery | Red LED flashes slowly |                             |

| Speaker - Charging case | Status                 | LED status               |
|-------------------------|------------------------|--------------------------|
|                         | Ready to pair          | Blue LED flashes quickly |
|                         | Connected              | Solid blue LED           |
|                         | Playing music          | Blue LED flashes slowly  |
| Low battery             | Red LED flashes slowly |                          |

## OPERATIONS & USE

### Earbuds control



| Play / Pause    | x2                            | x2                            |
|-----------------|-------------------------------|-------------------------------|
| Next track      |                               | x2                            |
| Voice assistant | x3*                           | x3*                           |
| Answer call     | x2*                           | x2*                           |
| Hang up call    | x2*                           | x2*                           |
| Reject call     | Press and hold for 3 seconds* | Press and hold for 3 seconds* |

\*Use either earbud to conduct these operations  
 You can independently use your left or right earbud by storing the one you don't want to use back in the charging case.

### Speaker control

|             |   |
|-------------|---|
| Turn On/Off | Press and hold the button for 3 seconds |
| Play/Pause  | Press the button once                   |

### Switch between Earbuds / Speakers

To switch from earbuds to speakers and vice versa, first make sure that both parts, Earbuds & Speaker, are connected to your mobile device.

#### Switch to Earbuds

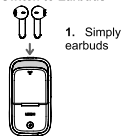

1. Simply take out the earbuds

#### Switch to Speaker

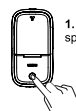

1. Press the button on the speaker to play your music

Note: You can also switch from one mode to another by selecting LEXON BUDS or LEXON SPEAKER as audio output from your mobile device

## CHARGING INSTRUCTIONS

### Earbuds

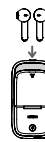

1. To charge the earbuds, place them into the charging case to initiate automatic charging
2. It will take about 1h30 to fully charge your earbuds in the charging case

The earbuds can deliver about 6 hours of battery life.  
 When reaching low battery level, you will hear an audio indication in your earbuds inviting you to put them back in the charging case to recharge them

### Charging case



1. To charge the charging case (Speaker), plug the supplied USB Type-C cable into the charging port of Speakerbuds
2. Plug the USB end of the cable into any 5V-1A power adapter
3. Plug the power adapter to a power source

The charging case offers an additional 20 hours of music to your earbuds  
 The speaker only can deliver about 6 hours of battery life.

## LED information

There are 4 LED indicators in the charging case to indicate its battery level. Simply insert the earbuds into the charging case to check the battery level.

- 1 4 LEDs ON = between 75% and 100%
- 1 3 LEDs ON = between 50% and 75%
- 1 2 LEDs ON = between 25% and 50%
- 1 1 LED ON = below 25% and requires your attention
- 1 LED OFF = 0% battery

When the charging case is powered, the light indicator next to the charging port turns red.

When the charging case is fully charged, the light indicator next to the charging port turns off.

## SAFETY PRECAUTIONS

Read all the instructions before using the device:

- To prevent possible hearing damage, do not listen at high volume levels for long periods of time.
- Use your earbuds with caution when engaging in any activity that requires your full attention.
- This package contains small parts that may be hazardous to children and should be kept out of reach from children. This product is not a toy never allow children to play with this product.
- Use of a power supply or charger that is not recommended may result in a risk of fire or injury.
- Do NOT submerge the earbuds in water.
- Do NOT expose charging case to water, rain, liquids or snow.
- Never try to dismantle the product yourself, or push objects of any kind into the products, as this may cause short circuits, which could result in a fire or electric shock.
- None of the components can be replaced or repaired by users.

## PRODUCT SPECIFICATIONS

### Charging case/Speaker

Product code: LA127-A  
 Material: ABS / PU leather  
 Dimensions: 9.9 x 5.2 x 2.5 cm / 3.89 x 2.04 x 0.98"  
 Weight: 76 g / 0.16 lbs  
 Operating temperature: -10° - 60°C / 14° to 140° F  
 Bluetooth version: 5.1  
 Bluetooth range: 10m / 33 ft  
 Bluetooth profiles: HSP, HFP, A2DP, AVRCP  
 Frequency range: 80Hz - 20kHz  
 Operation Frequency: 2402-2480MHz  
 Signal & noise ratio: ≤ 85 dB  
 Rated power: 2.5W  
 Impedance: 4Ω  
 Max. output power: 3W  
 Transmitter power: 1.63dBm  
 Input: 5V-1A  
 Battery capacity: Li-polymer 400 mAh  
 Battery voltage: 3.7V  
 Charging time: 2h  
 Battery life: 5h of playtime for speaker only  
 Connection type: USB Type-C (cable included)

### Earbuds

Product code: LA127-B  
 Material: ABS  
 Dimensions: 4.1 x 1.8 x 1.7 cm / 1.61 x 0.71 x 0.67 »  
 Weight: 4 g (each) / 0.01 lbs  
 Sound: Environmental noise cancellation with dedicated mic  
 Bluetooth version: 5.2  
 Bluetooth range: 10m  
 Bluetooth profiles: HSP, HFP, A2DP, AVRCP  
 Frequency range: 20Hz - 20kHz  
 Operation Frequency: 2402-2480MHz  
 Signal & noise ratio: ≤ 95 dB  
 Earbud impedance: 16Ω  
 Transmitter power: 1.06dBm  
 Battery capacity: Li-polymer 40 mAh  
 Battery voltage: 3.7V  
 Charging time: 1h30  
 Battery life: 6h of playtime and the charging case offers a further 20 hours of battery life for earbuds only

Compatibility: with iOS and Android devices  
 International warranty: 1 year